



WORLD CLASS SUSPENSION  
www.ysssuspension.com



**Y.S.S. (Thailand) Co., Ltd.**

88/88 M9 Soi Phikulthong Thepharak Rd.  
Bangpla, Bangphli, Samutprakarn 10540 Thailand  
Tel : +66 2706 3700, +66 2736 8600  
Fax : +66 2736 8899

## YSS MX PISTON KIT 50 mm. INSTALLATION MANUAL



www.ysssuspension.com



YSS-THAILAND

YSSCUSTOMERSP

# YSS MX PISTON KIT 50 mm. INSTALLATION MANUAL



## SETTING PART LIST

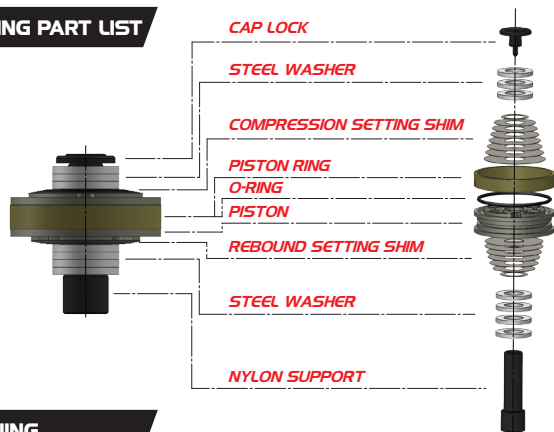

## WARNING

1. Please read owner's manual carefully before Installing and Adjusting
2. Choose correct specification of MX Piston Kit for your motorbike and consult our YSS Service Center, [www.ysssuspension.com](http://www.ysssuspension.com)

## INSTALLATION

1. Remove Shaft (Damper Rod) assembly from Shock
2. Remove Original Piston assembly from Shaft (Damper Rod).
3. Clean Shaft & Damper tube.
4. Take Cap lock from YSS PISTON KIT out with care.

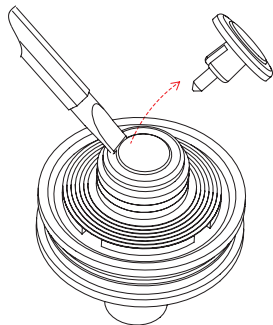

5. Assemble YSS PISTON KIT to the Shaft (Damper Rod). (Take the end Nylon shaft connect to the end Shaft and move YSS PISTON KIT SETTING from NYLON SUPPORT to Shaft (Damper Rod).)

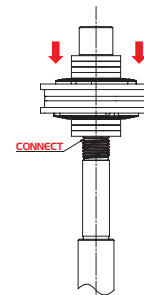

6. Refit Nut to Shaft (Damper Rod). (Torque = 16 N\*m)

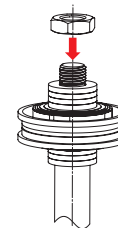

7. Fit PISTON RING assembly to the PISTON.

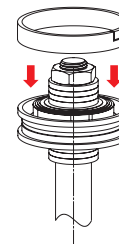

8. Refit Shaft (Damper Rod) assembly to Shock Body.

