

# HONDA CBR 250RR 2016

COMPRESSION  
ADJUSTMENT - COMP.

REBOUND  
ADJUSTMENT - REB.

SPRING PRELOAD  
ADJUSTMENT

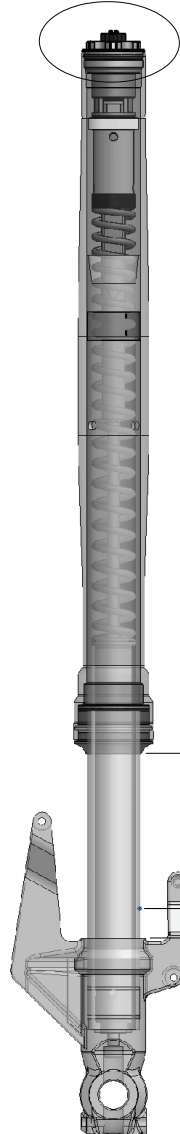
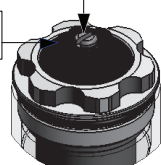
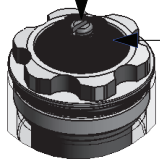

Recommended Adjustment Setup	
Rebound Adjustment	15 Clicks
Compression Adjustment	15 Clicks
Spring Preload	As Per - Spring Chart
Oil Level mm.	150 mm. (Recommended)
Stroke mm.	160 mm.
Fork Position Top Clamp - mm.	

Rider Weight (Kgs.)	50	60	70	80	90	100
Spring Rate (N/mm)	6	6.5	7	7.5	8	8.5
Preload (mm)	4	5	6	6	7	7
Part Number (Single)	LR300AO 60S320A OR-G	LR300AO 65S320A OR-G	LR300AO 70S320A OR-G	LR300AO 75S320A OR-G	LR300AO 80S320A OR-G	LR300AO 85S320A OR-G

Fork Position  
Top Clamp

OEM  
0 mm.

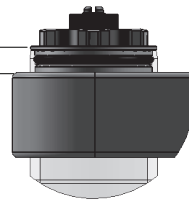

**NOTE :**  
To Count the Rebound and Compression Clicks-  
from Fully Closed-Turn anticlockwise

WORLD CLASS SUSPENSION

CARTRIDGE KIT

**YSS**  
SUSPENSION

**HONDA**  
CBR 250RR '2016



www.ysssuspension.com

# FORK CARTRIDGE KIT PART LIST

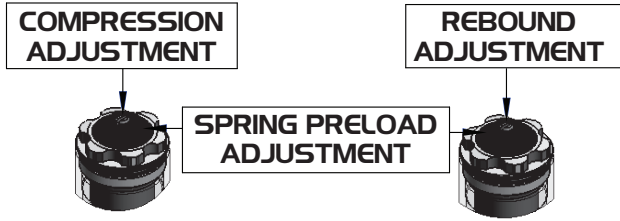

- A- Cartridge 20 mm.
- B- Fork Cap Se
- C- Top Spacer
- D- Preload Tube
- E- Spring
- F- Spring Washer

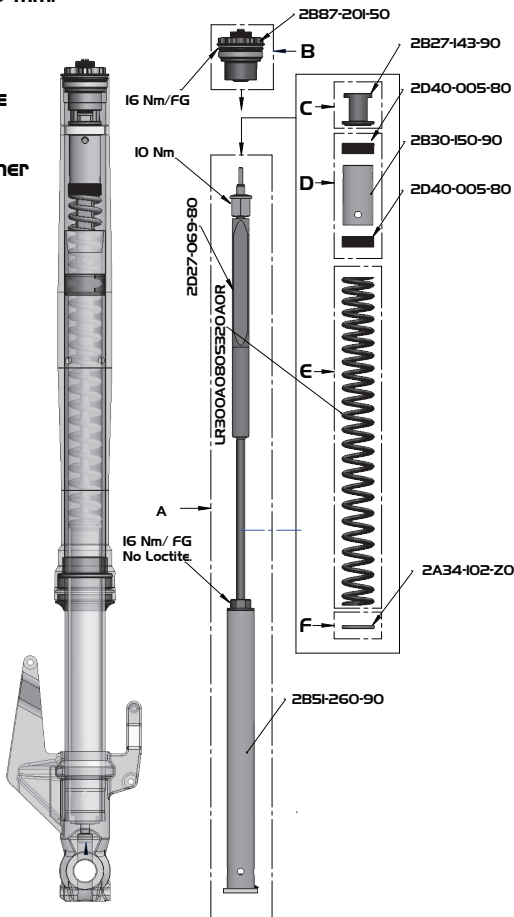

Warning : Fitting should be carried out by Authorized Service Center or contact YSS Factory

# ASSEMBLY INSTRUCTIONS

**\*\*\* Note\*\*\***  
**Compression LH Fork**  
**Rebound RH Fork**  
**Start with LH Side First. Do One Fork at a Time,so not to mix up Parts**

1. Remove - original Fork Kit
2. Thoroughly Clean Fork tubes and Fork bottoms .
3. Reassemble Bushings and Oil retainer on the Tubes and grease all sliding parts.
4. REMOVE FORK INNER TUBE FROM THE AXLE CLAMP- INSTALL YSS CARTRIDGE KIT ON THE END OF FORK INNER TUBE AS PER PICTURE (USE HEAT GUN AT 600C / 5 Minute FOR DISSOLUTION THE GLUE LOCK) Position the Fork Kit "A" inside the Fork Tube. Make sure it is firmly on its bottom base.

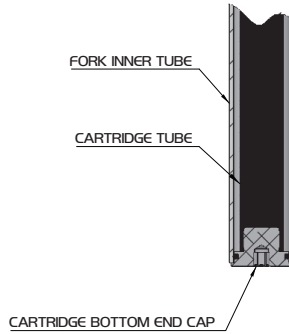

5. ASSEMBLY THE FORK INNER TUNE WITH CARTRIDGE KIT TO THE AXLE CLAMP (ASSEMBLY LOCK BY GLUE (LOCTITE 638) In this case carefully repeat last step.

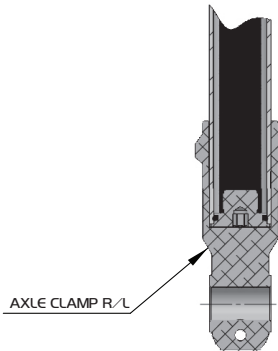

# OIL BLEEDING INSTRUCTIONS

1. Slowly pour YSS Fork Fluid No.10 into the Fork so that it flows inside the Cartridge 50 mm. above Damping Tube.Slide Rod up and down several times to bleed any Air bubbles out of the Cartridge System.
2. Adjust Oil level according to the Instructions of the Setup .

**Note : Oil level must be measured without Spring and Preload Tube. Fork Completely Compressed.**

3. Position the Fork Kit Parts as following.
  - "F" Spring Washer
  - "E" Spring
  - "D" Preload Tube
  - "C" Top Spacer.
4. Use Tooling to extent to Photo of This Procedure. Use 17 mm. YSS Spanner+ Pull up Tooling.
5. Position the Fork Cap "B"

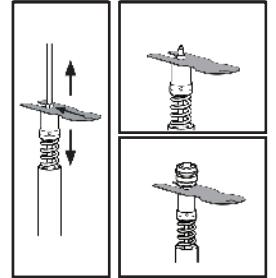

**Note : Tighten the Damping Rod on the Fork Cap.**

6. Screw the Fork Cap onto the Fork Tube. Make sure you do not damage the O-ring placed under the Fork Cap.
- Ready to Reassemble in Motorcycle Torque all Bolts to Factory Specs. Set Adjusters as per Spec Sheet.Test Ride and Adjust to Suit.**

