



SPEC TABLE FOR YSS FORK UPGRADE KIT

BRAND	ITEM NO.	MODEL	MODEL YEAR	VIN CODE	CC	FORK UPGRADE CODE	OIL SPECIFICATION		PRELOAD START (mm.)	TYPE INSTALLATION	FORK TUBE CLAMP SIZE (mm.)	REMARK
							OIL NO. (cst.)	OIL HIGH (mm.)				
BMW	1	F 650GS	07-12	E8GS/K72	798	Y-FCC36-KIT-09-001	20W	165	10	TYPE 4	41	
HARLEY DAVIDSON	2	XL1200 CUSTOM	08 >	CT3	1200	Y-FCM34-KIT-05-001	20W	130	55	TYPE 2	39	
	3	SPORTER ROADSTER 883 R	07-15	CS2	883	Y-FCM34-KIT-05-002	20W	175	30	TYPE 2	39	
HONDA	4	PCX 150	15>	KF19A	150	Y-FCM26-KIT-01-001	20W	80	6	TYPE 1	31	
	5	CLICK 125i	12>	ANC125BCTD	125	Y-FCC21-KIT-01-002	20W	70	20	TYPE 1	26	
	6	WAVE 110i	13>	NS110P/NS110D/NS110S	110	Y-FCC21-KIT-01-003	20W	60	17	TYPE 1	26	MODIFY FRONT FENDER
	7	WAVE 125i	13>	AFS125MS,MCS,MCR	125	Y-FCC21-KIT-01-004	20W	100	10	TYPE 1	26	MODIFY FRONT FENDER
	8	CBR 250R	11-16	MC41A/B	250	Y-FCM33-KIT-01-006	20W	165	25	TYPE 4	39	
	9	CB 500F	14>	PC45A	500	Y-FCM37-KIT-01-007	20W	135	12	TYPE 4	41	
	10	CB 650F	14>	RC75	650	Y-FCM37-KIT-01-008	20W	150	30	TYPE 4	41	
	11	FORZA 300	13>	NSS300AD	300	Y-FCC31-KIT-01-009	20W	75	12	TYPE 2	35	
	12	CBR 500R	14>	PC44B	500	Y-FCM37-KIT-01-010	20W	135	12	TYPE 4	41	
	13	CB 500X	14>	PC46B	500	Y-FCM37-KIT-01-011	20W	135	20	TYPE 4	41	
	14	CBR 650F	14>	RC74B/C	650	Y-FCM37-KIT-01-012	20W	150	25	TYPE 4	41	
	15	NC 700	14>	NC700S	700	Y-FCM37-KIT-01-013	15W	100	20	TYPE 4	41	
	16	NC 750	15>	RC72B/C,RC90A/B	750	Y-FCM37-KIT-01-014	15W	100	30	TYPE 4	41	
	17	REBEL 500	17>	CMX 500	500	Y-FCM37-KIT-01-015	20W	150	25	TYPE 4	41	
	18	DREAM SUPER CUB	14-17	NBC110	110	Y-FCM20-KIT-01-016	20W	90	13	TYPE 2	26	MODIFY FRONT FENDER
	19	PCX 150i	18>	KF28	150	Y-FCC26-KIT-01-017	20W	65	8	TYPE 1	31	
KAWASAKI	20	NINJA 250/NINJA 300	13>	EK250K/EX300A	250/300	Y-FCC32-KIT-02-001	20W	125	20	TYPE 4	39	RACING ONLY (CLIP ONS)
	21	ER-6N/NINJA 650	12-16	ER650E	650	Y-FCM38-KIT-02-002	20W	110	23	TYPE 4	41	
	22	Z 650 / NINJA 650	17>	JKAER650HDDA05492	650	Y-FCM38-KIT-02-003	20W	100	25	TYPE 4	41	
	23	W 800	12>	EJ800A	800	Y-FCM34-KIT-02-004	10W	120	25	TYPE 4	39	
	24	Z 250	13>	-	250	Y-FCC33-KIT-02-005	20W	125	15	TYPE 4	39	
	25	Z 300	13>	ER300A	300	Y-FCC32-KIT-02-006	20W	110	20	TYPE 4	39	
	26	NINJA 250SL/Z 250SL	15>	BX250A/BR250E	250	Y-FCC33-KIT-02-007	30W	160	15	TYPE 4	39	
	27	KLX 140	17>	KLX140AHF	140	Y-FCM29-KIT-02-008	15W	130	10	TYPE 4	35	
	28	W 175	17>	MH4BJ175AAJP00148	175	Y-FCM25-KIT-02-009	20W	200	12	TYPE 2	31	
29	NINJA ZX250 / NINJA ZX400	18>	-	250/400	Y-FCM37-KIT-02-010	20W	100	18	TYPE 4	41		
ROYAL ENFIELD	30	CLASSIC 500	09-17	ME3CKE	500	Y-FCM30-KIT-08-001	20W	270	15	TYPE 5	35	CAN NOT ADJUSTMENT SPRING PRELOAD
	31	BULLET 500	09-17	ME3CKD	500	Y-FCM30-KIT-08-002	20W	270	17	TYPE 5	35	CAN NOT ADJUSTMENT SPRING PRELOAD
	32	HIMALAYAN	18>	-	400	Y-FCM38-KIT-08-003	20W	220	5	TYPE 4	41	
SUZUKI	33	GSX-R 150	17>	-	150	Y-FCC26-KIT-03-002	30W	125	20	TYPE 4	31	
TRIUMPH	34	BONNEVILLE T100	12-16	SMTTJ9152G,SMTTJ9157G	900	Y-FCM38-KIT-06-001	20W	115	17	TYPE 4	41	
	35	STREET SCRAMBLER	17>	-	900	Y-FCM38-KIT-06-002	20W	115	15	TYPE 3	41	
	36	SCRAMBLER 900	12>	SMTTJ9171G/SMTTJ9178G	900	Y-FCM38-KIT-06-003	20W	125	18	TYPE 4	41	
	37	TRUXTON 900	12-16	SMTTJ9147G	900	Y-FCM38-KIT-06-004	20W	145	25	TYPE 4	41	
	38	BONNEVILLE T100	17>	-	900	Y-FCM38-KIT-06-005	20W	115	15	TYPE 3	41	
	39	STREET TWIN	16-17	-	900	Y-FCM38-KIT-06-006	20W	100	12	TYPE 4	41	
	40	BONNEVILLE BOBBER	16>	SMTDAD76HWH	1200	Y-FCM38-KIT-06-007	20W	150	35	TYPE 3	41	
YAMAHA	41	N-MAX 155	15>	GPD150-A	155	Y-FCC25-KIT-04-001	20W	60	15	TYPE 1	31	
	42	AEROX 155	17>	GDR155/A/R	155	Y-FCC21-KIT-04-002	20W	70	30	TYPE 2	26	
	43	YZF-R3	14>	YZFR3A	250/320	Y-FCM38-KIT-04-003	20W	100	15	TYPE 4	41	
	44	EXCITER 150	15>	T150	150	Y-FCC21-KIT-04-004	20W	75	25	TYPE 2	26	REMOVE THE HORN BRACKET
	45	YZF-R15	14-16	YZFR15	150	Y-FCM30-KIT-04-005	15W	120	20	TYPE 4	35	
	46	JIPITER RC	16>	-	115	Y-FCC21-KIT-04-006-X	20W	90	17	TYPE 2	26	MODIFY FRONT FENDER
	47	GT 125	15>	LNR125	125	Y-FCC21-KIT-04-007	20W	100	25	TYPE 2	26	
	48	MT-07	15>	RM04	689	Y-FCM38-KIT-04-008	20W	160	10	TYPE 4	41	
	49	Q-BIX (NO ABS)	17>	LTV125	125	Y-FCC21-KIT-04-009	20W	70	15	TYPE 2	26	
	50	X-MAX	17>	CZD300-A	300	Y-FCM30-KIT-04-010	20W	205	20	TYPE 4	35	
	51	SR400/SR400FI	08-17	JYARH051	400	Y-FCM28-KIT-04-011	20W	150	17	TYPE 2	35	
	52	X-MAX (SHORTEN L -30)	17>	CZD300-A	300	Y-FCM30-KIT-04-012	30W	110	5	TYPE 5	35	CAN NOT ADJUSTMENT SPRING PRELOAD
	53	Q-BIX (ABS)	17>	LTV125	125	Y-FCC21-KIT-04-013	20W	70	15	TYPE 2	26	



In order to use with the highest performance, we suggest to use fork upgrade kit with YSS fork fluid only.

TECHNICAL SERVICE

TEL : 0-2033-0779

www.ysssuspension.com

e-mail : technicalservice@yss.co.th

TYPE OF FORK UPGRADE KIT

TYPE 1

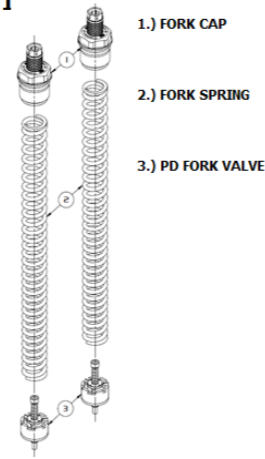

TYPE 2

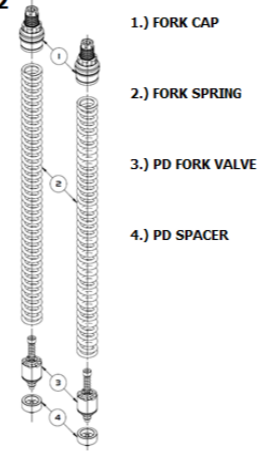

TYPE 3

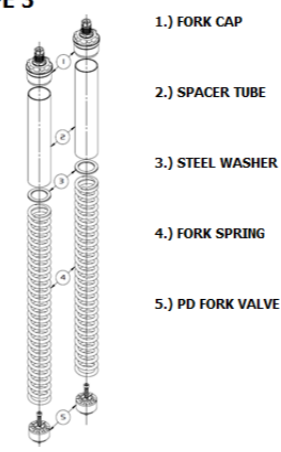

TYPE 4

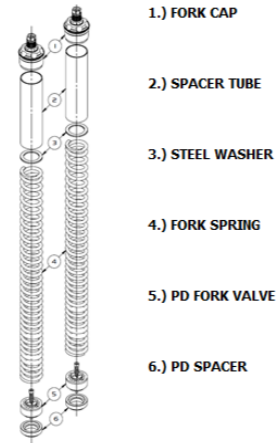

TYPE 5

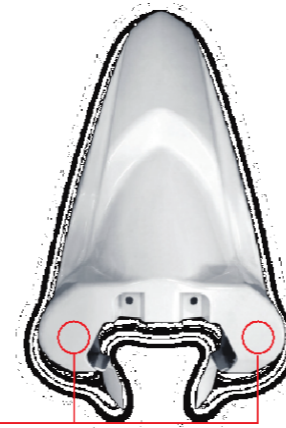
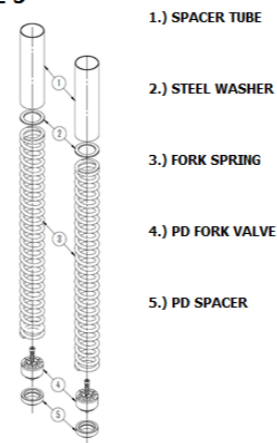

MODIFY THE FRONT FENDER FOR PRELOAD ADJUSTER (ON THE CENTER FROM INNER TUBES)

TOP CAP PRELOAD ADJUSTER SETTING

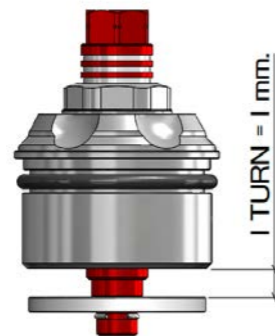

PROLOAD START MEASURE METHOD (CLIP LOCK)

PRELOAD = X+(P1+P2)

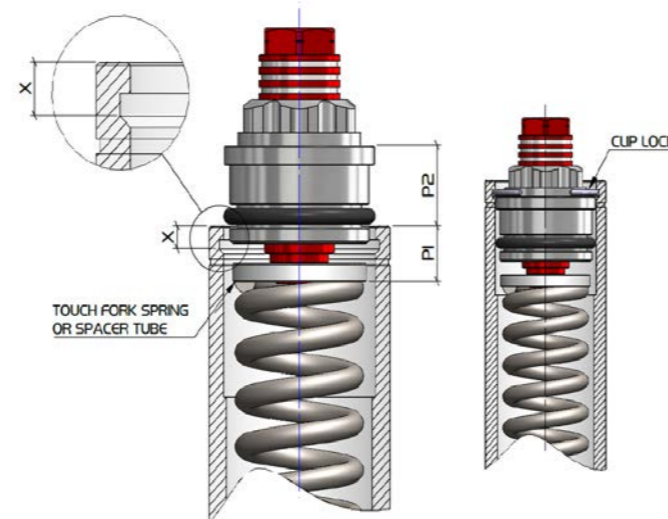

PROLOAD START MEASURE METHOD (THREAD LOCK)

